



# DORIS DAY DOG PARK RENOVATIONS & IMPROVEMENTS

2970 WESTWOOD NORTHERN BLVD, CINCINNATI, OH 45211





Tater Tot



Winnie



Peanut



Harbor



Maya



Boss Man

# MEET THE TEAM



Fluffaluffagus



Charcoal



Sleepy

A Bernese Mountain Dog is sitting on a grassy lawn, looking up at a person standing next to it. The person is wearing a blue patterned jacket and dark pants, and is holding a small treat in their hand. The dog has black, white, and brown fur and is wearing a pink collar. The background shows a wooden fence and some greenery. The text "MEETING RULES" is overlaid in the center of the image in a white, bold, sans-serif font.

# MEETING RULES

- 
- A Bernese Mountain Dog is sitting on a grassy field, looking up at a person's hand holding a treat. The person is wearing a blue patterned jacket and dark pants. The background is a soft-focus green field. The text 'MEETING RULES' is overlaid in large, white, semi-transparent letters across the middle of the image.
1. Presentation is being recorded.
  2. Attendees will be muted during the presentation.
  3. A public comment/discussion period will be held at the end of the presentation.
  4. You can use the “chat” function to add questions to the queue, these will be answered during the comment/discussion period.
  5. During the comment/discussion period, attendees will be muted unless called upon.
  6. To be selected for comment, “raise hand” on zoom, you will be unmuted when it is your turn to comment.
  7. We love all of our parks, but comments and discussion will be limited to feedback on Mt. Airy Doris Day Dog Park only.
  8. An online survey will be made available as an additional feedback option.
  9. Survey will be available for one month, survey results will be posted online.
  10. Be open and honest, all feedback is helpful and we greatly appreciate your input!

# THIS PARK MATTERS!

- Largest dog park managed by Cincinnati Parks.
- Unique to this region:
  - It's big! Nearly 4 acres of play area.
  - Areas for both big and small dogs.
  - Water, shelter, and restroom amenities.
- Few other dog park options exist on the west side and surrounding neighborhoods.

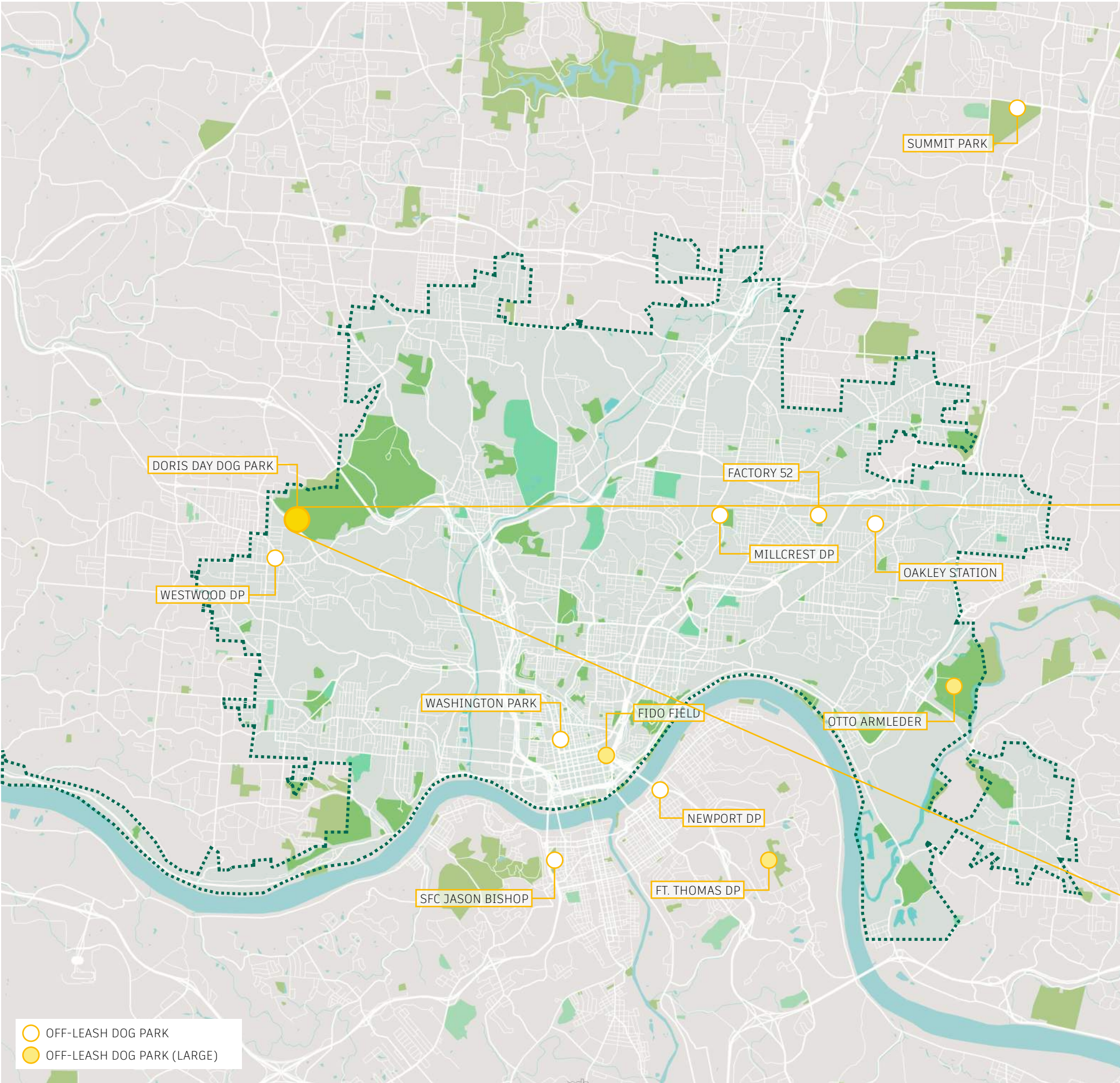

♥ WHY WE LOVE OUR PARK ♥



LOTS OF SPACE



TREES AND  
SHADE

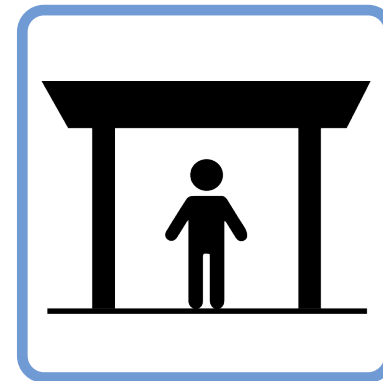

SHELTERED SEATING  
AND RESTROOMS

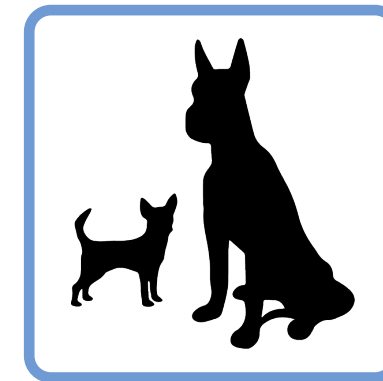

BIG/SMALL DOG  
AREAS



WATER  
AMENITIES

# HERE'S WHAT WE'VE DONE ALREADY



TREE  
MANAGEMENT



REPAIR  
LEAKS



SANITATION  
REPAIRS



ADDED WASTE AND  
SEATING AMENITIES

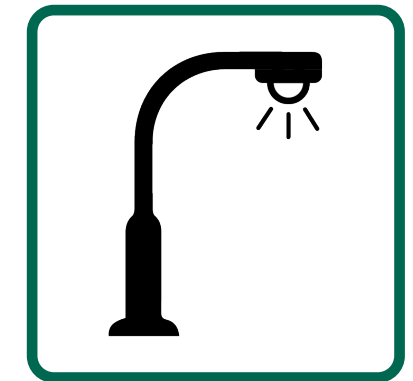

REPAIRED  
EXISTING LIGHTS  
(TODAY!)

# ISSUES FACING OUR DOG PARK



INFRASTRUCTURE  
PROBLEMS

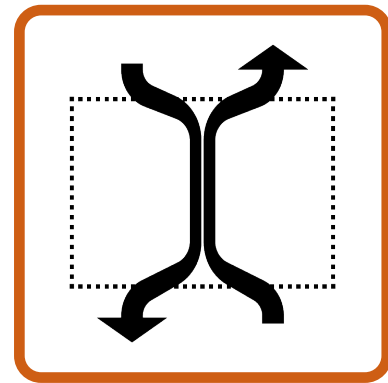

DIFFICULT ENTRY/  
EXIT



OUTDATED  
AMENITIES



AGE OF PLAY  
EQUIPMENT



MUDDY SITE/  
MULCH LOSS

# WHAT CAN WE DO?



IMPROVE SITE  
INFRASTRUCTURE

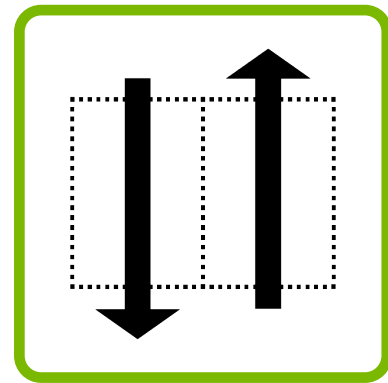

NEW IMPROVED  
ENTRY



ORGANIZE / ADD  
AMENITIES



NEW PLAY  
EQUIPMENT

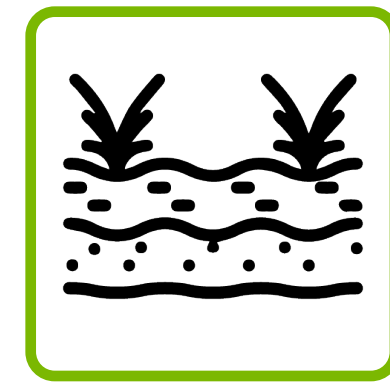

NEW RESILIENT  
SURFACING AND  
LANDSCAPING



## INFRASTRUCTURE PROBLEMS

- Road/pathway to Dog Parks and Comfort Station is in severe disrepair and in need of remediation.
- Bollards at mouth of road are heavily damaged and blocking path of travel.
- Pathway would benefit from additional park-branded signage to post park/trail map and dog park rules, as well as provide additional spots for waste disposal bags.
- Signage in dog play areas no longer Parks standard.





## IMPROVE SITE INFRASTRUCTURE

- Re-pave damaged pathway surface.
- Remove gravel topping and replace with appropriate sod or mulch (landscape potential).
- Install updated Parks signboard with park map and dog rules posted.
- Replace bollards and install middle removable bollard to allow travel along path, instead of around bollards.

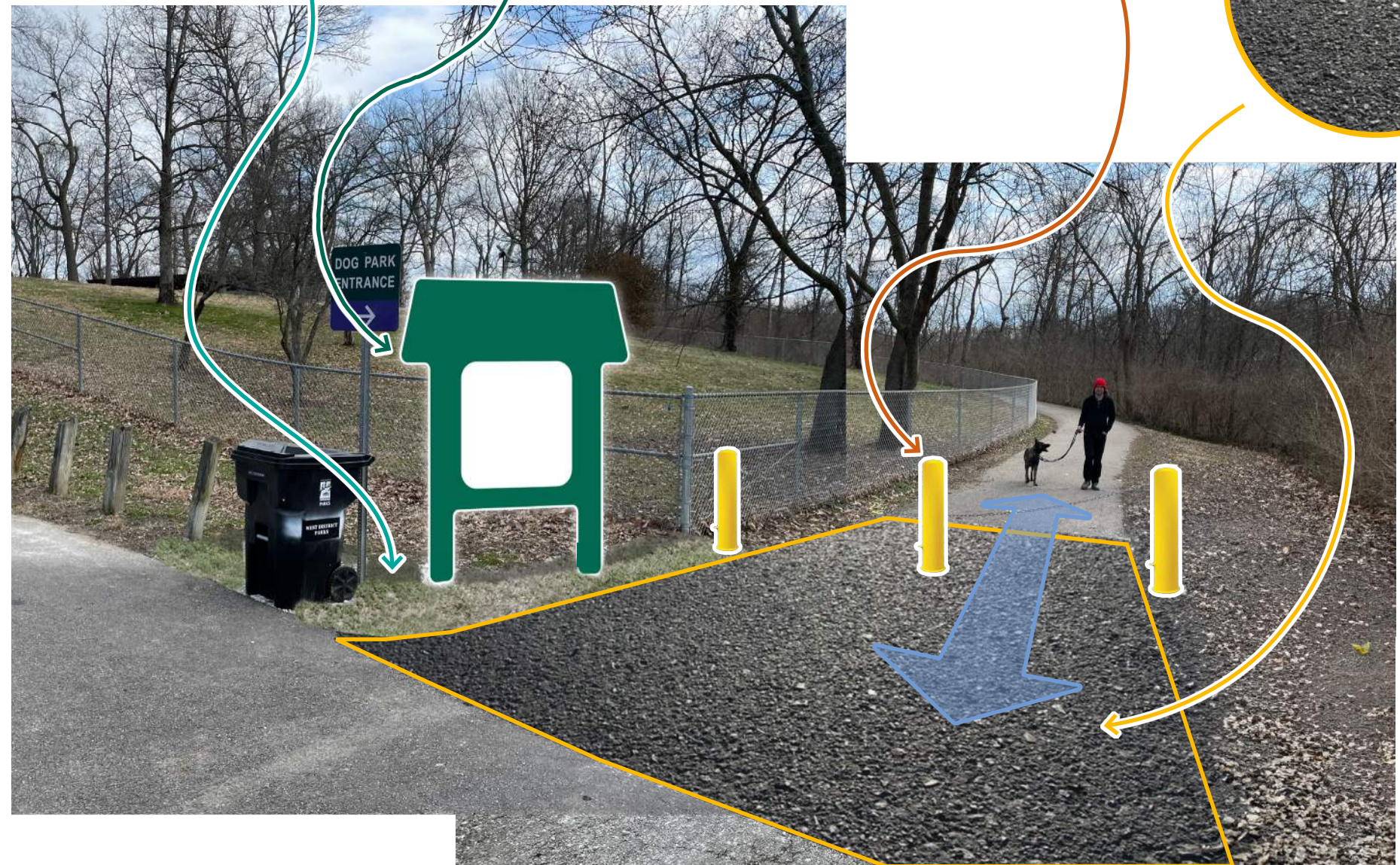

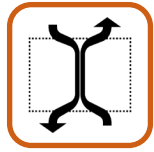

## DIFFICULT ENTRY / EXIT

- Only one “air-lock” or “vestibule” entry at both big and small dog areas  
(particularly a problem in the big dog area)
- This bottleneck can be hazardous for people entering and exiting, causing a “rush” of dogs in the fenced area at the gate when a new dog enters.
- Dirt/mud tracks into the vestibule, and can leave dogs dirty on their way back to their cars.



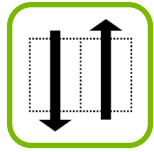

## NEW IMPROVED ENTRY

- Dual entry vestibules will give dogs and their people entering and exiting the park some respite.
- Entrances on the side of the vestibules allows for greeting dogs to gather at non-entry points.
- Greatly improves safety and flow.

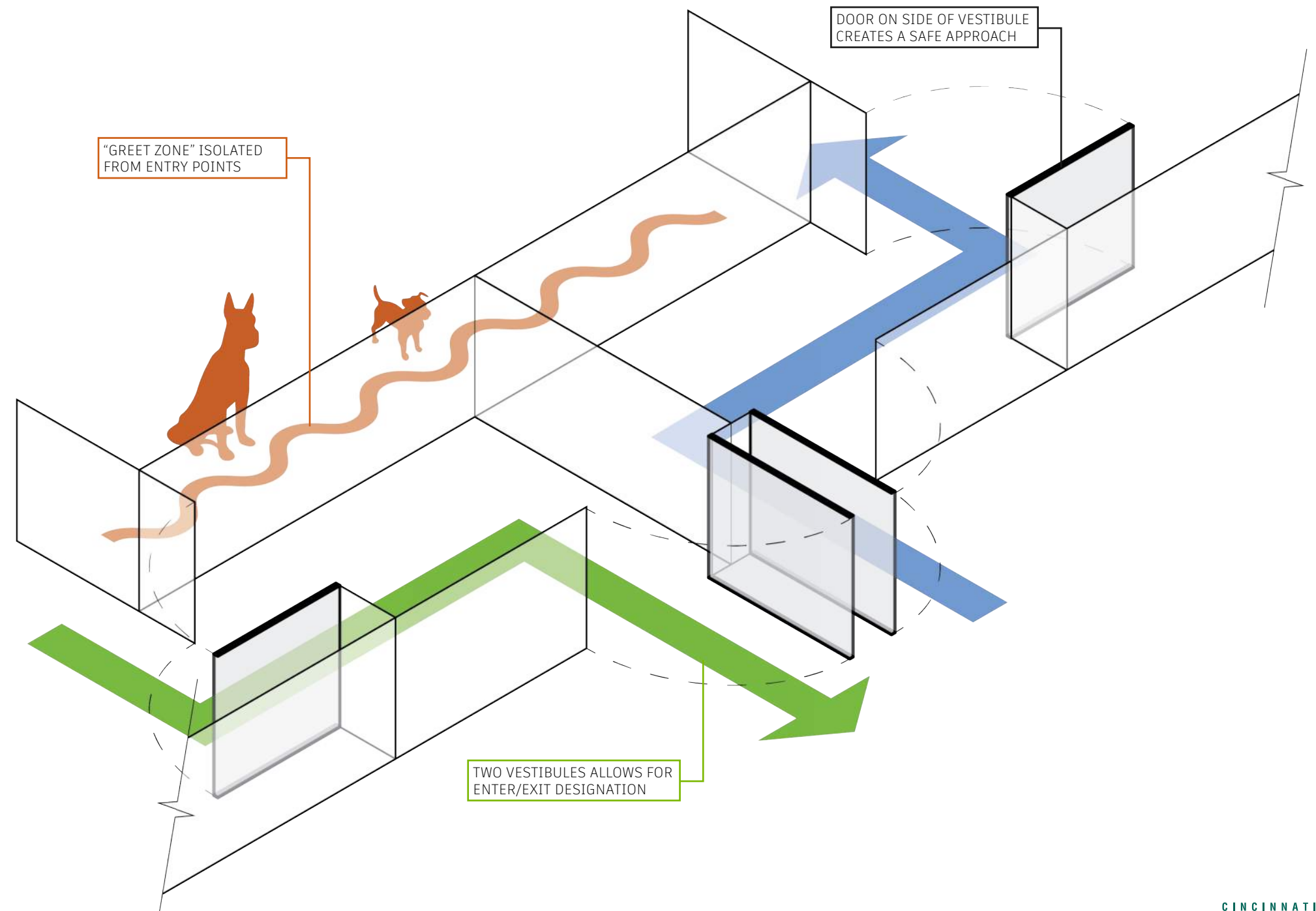



## OUTDATED AMENITIES

- Amenities throughout the park are in various states of aging and decay, past their useful lifespans, and in need to repair, replacement, or removal.
- Additional tables have been added, however they are haphazardly placed around the park rather than more organized.
- Amenities to be addressed include:
  - Picnic Tables
  - Benches
  - Trellis Shade Structures
  - Trash Cans
  - Dog Waste Bag Stations
  - Park Signs
  - Grill Stations
  - Water Fountains and Bowls





## ORGANIZE / ADD AMENITIES

- Introduce additional seating as needed and organize in grouped gathering zones along dog run perimeter.
- Upgrade and install additional waste receptacles and disposal bag stations at dog area perimeters.
- Update water fountain amenities to include built-in dog bowl and pool filler.
- Opportunities for constructing additional shade structures may be explored with public partnerships.

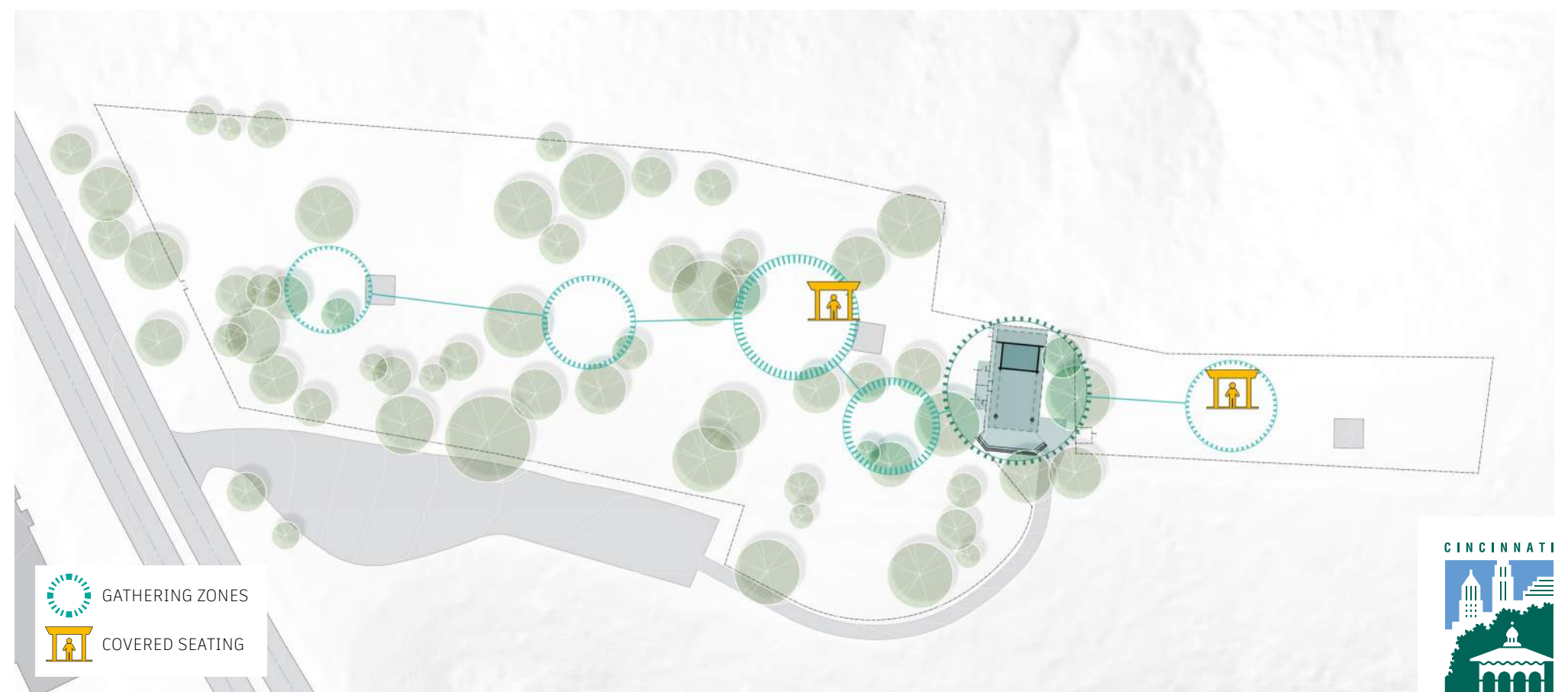



## AGE OF PLAY EQUIPMENT

- Play equipment in the park is in various states of age and deterioration, and is way past it's useful lifespans.
- Current play equipment offerings are minimal and underutilized, a broadening of equipment types would likely result in more engagement and dog play.
- No natural material integration in existing equipment.





## NEW PLAY EQUIPMENT

- Install new play equipment in both large and small dog play areas, and remove old equipment.
- Explore both active and casual groupings of equipment.
  - Explore both natural and artificial installations
    - Natural play equipment (downed trees, logs) would have a reduced usable lifespan due to rot.
    - Artificial play equipment could have a much longer usable lifespan.
    - Likely explore a combination of both.
- Parks to explore if supplying secured water play pools is feasible.

## TYPES OF PLAY EQUIPMENT BEING EXPLORED\*:



RAMPS / A-FRAMES



RING JUMPS



STEPPING PADS



PLATFORMS / TABLES



JUMP BARS



TUNNELS



RING RUNS



WEAVE COURSES



STRUCTURES



MOUNDS



DOWNED TREE CLIMBING



FAUX TREE CLIMBING





## MUDDY SITE / MULCH LOSS

- Heavy-use and runoff removes mulch and topsoil over time.
- Exposed dirt and soil is prone to erosion and runoff, further exacerbating the problem.
- Loss of soil exposes roots systems, which are a potential tripping hazard.

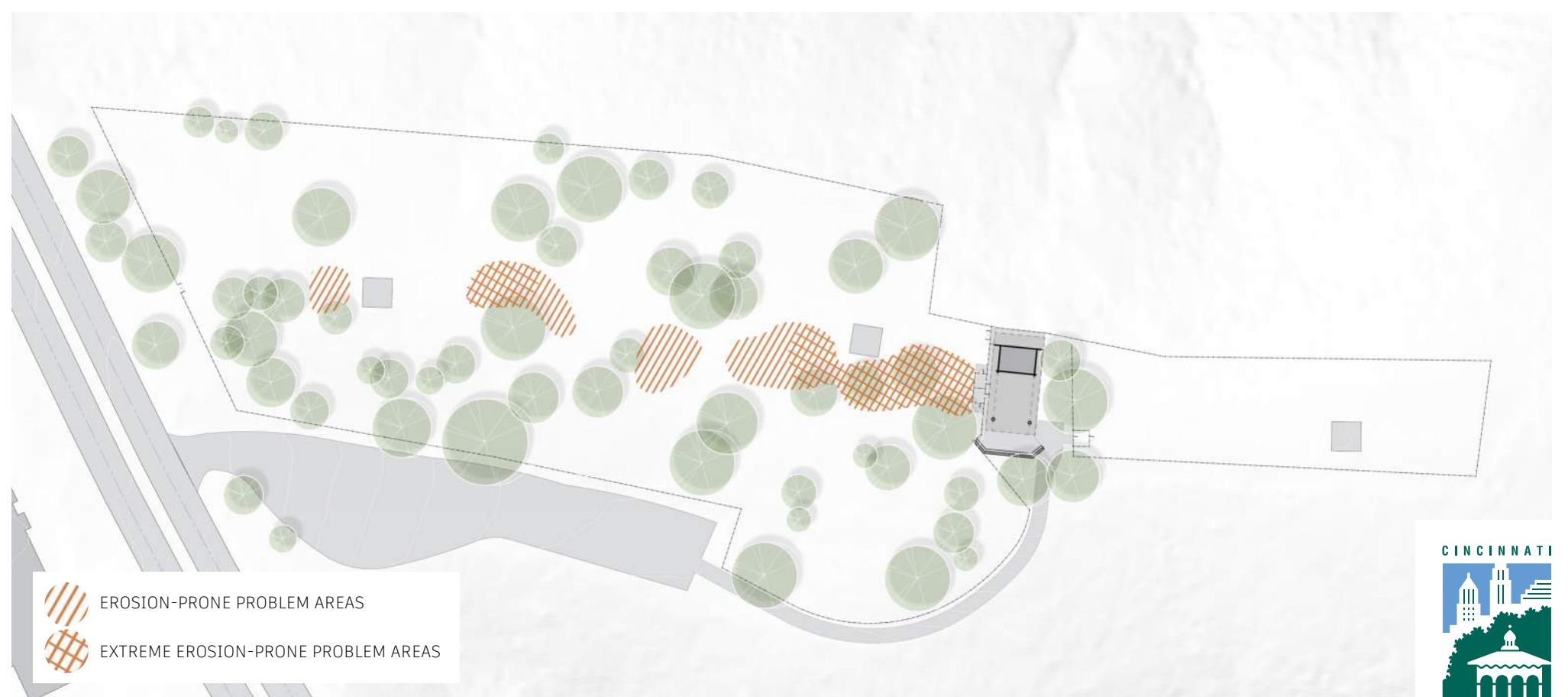
Mud + Paws = *Yuck!*



 EROSION-PRONE PROBLEM AREAS  
 EXTREME EROSION-PRONE PROBLEM AREAS



## NEW RESILIENT SURFACING AND LANDSCAPING

- Controlling erosion will prevent surface loss, pitting, and pooling. Erosion control methods include:
  - Soil Substrate Layer
  - Run-Off Resistant Top Surface
- Research on solutions is ongoing, installations should be:
  - Non-Toxic
  - Minimally intrusive
  - Edged
  - Sensitive to tree root systems
  - Water-Permeable / Porous
  - Paw-friendly
  - Easy to maintain or fill in as needed
  - User-Friendly

### SUBSTRATE OPTIONS BEING EXPLORED:



GEOCELL / GEOWEB



KENNEL TILE

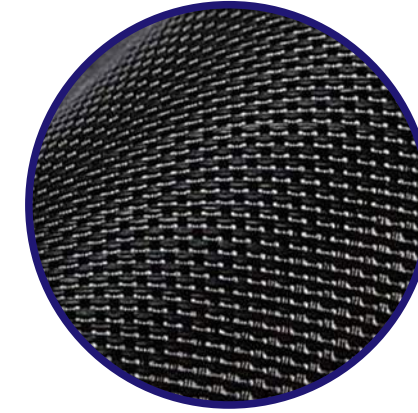

GEOTEXTILE

### TOPPING SURFACE OPTIONS BEING EXPLORED:



WOOD CHIPS / MULCH



PEA GRAVEL



RECYCLED RUBBER MULCH

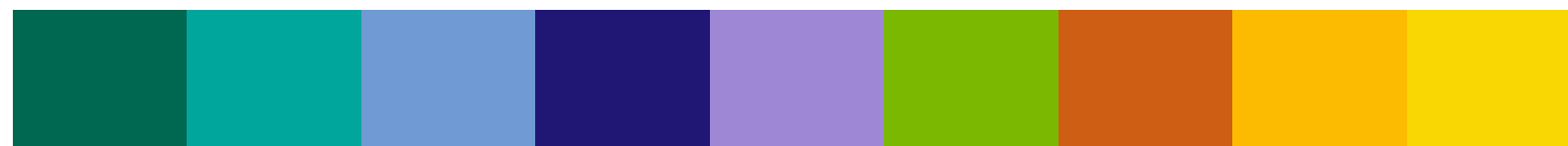

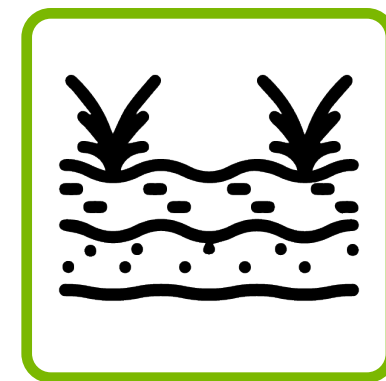
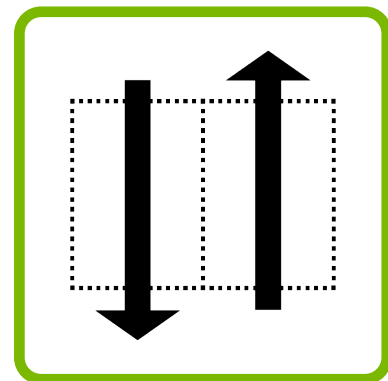
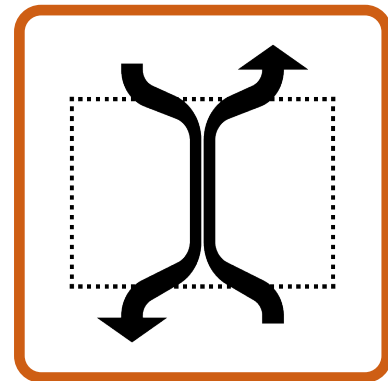
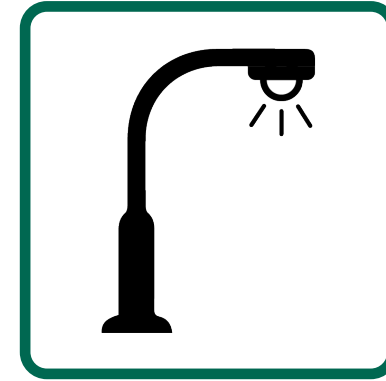
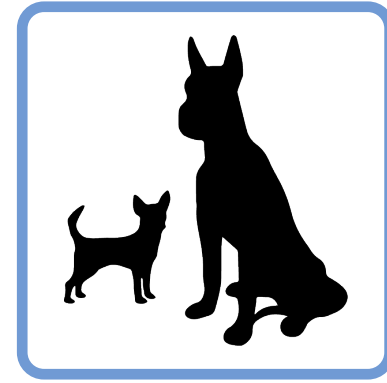

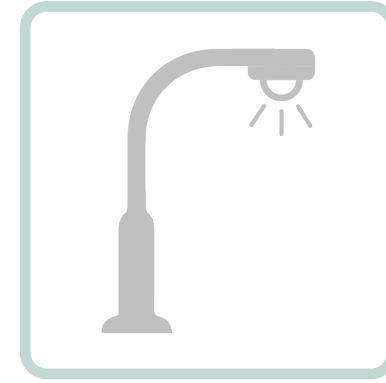
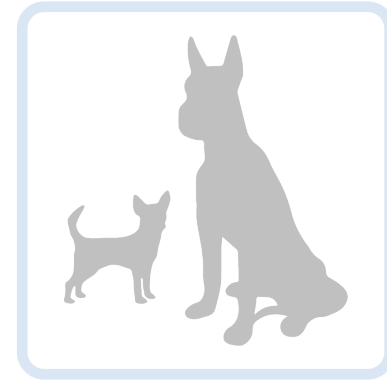

# PRIORITIES?

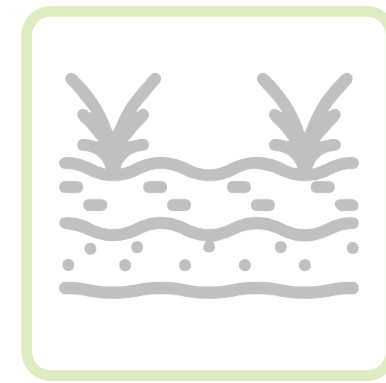
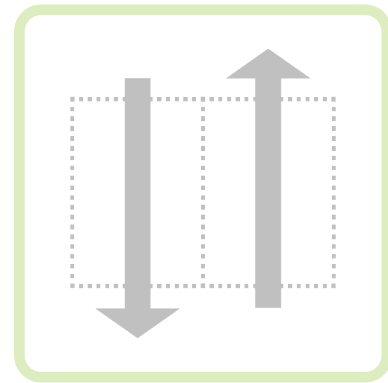
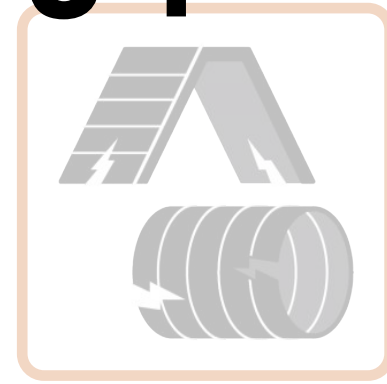
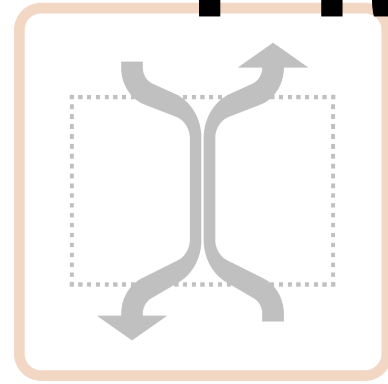



THE BIG PICTURE

# DESIGN DRIVERS

Identifying diagrammatic factors of the site.

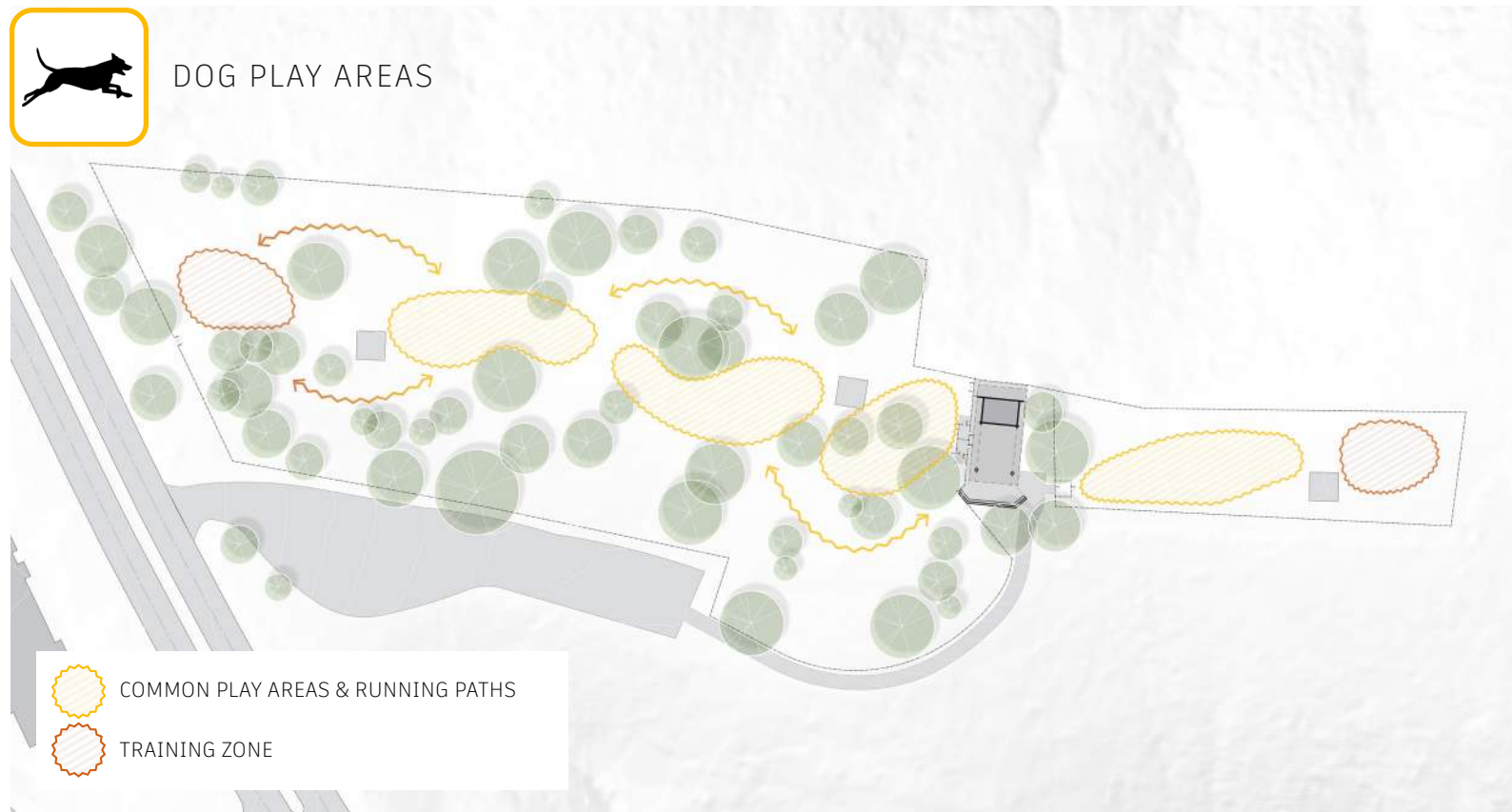
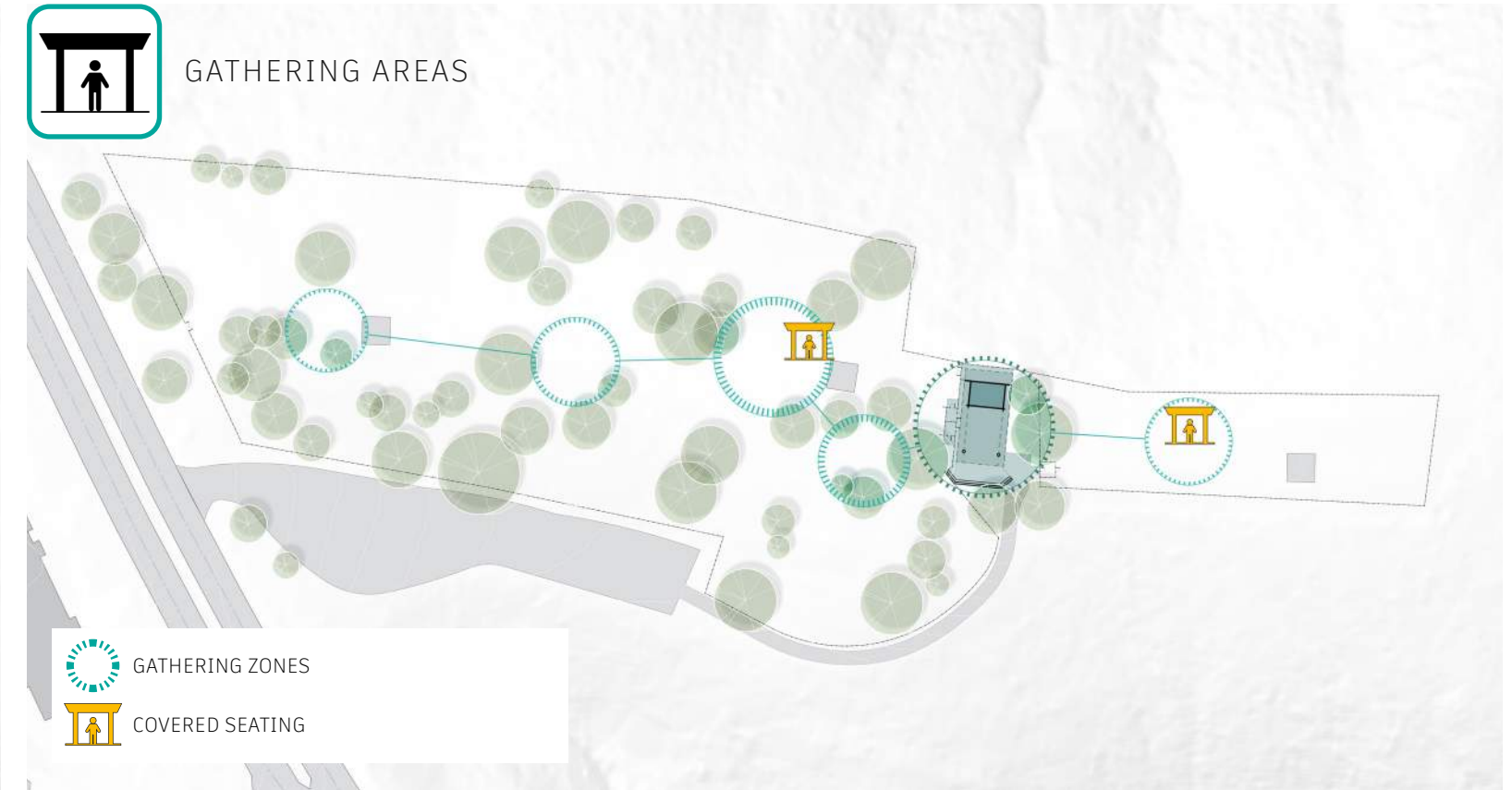
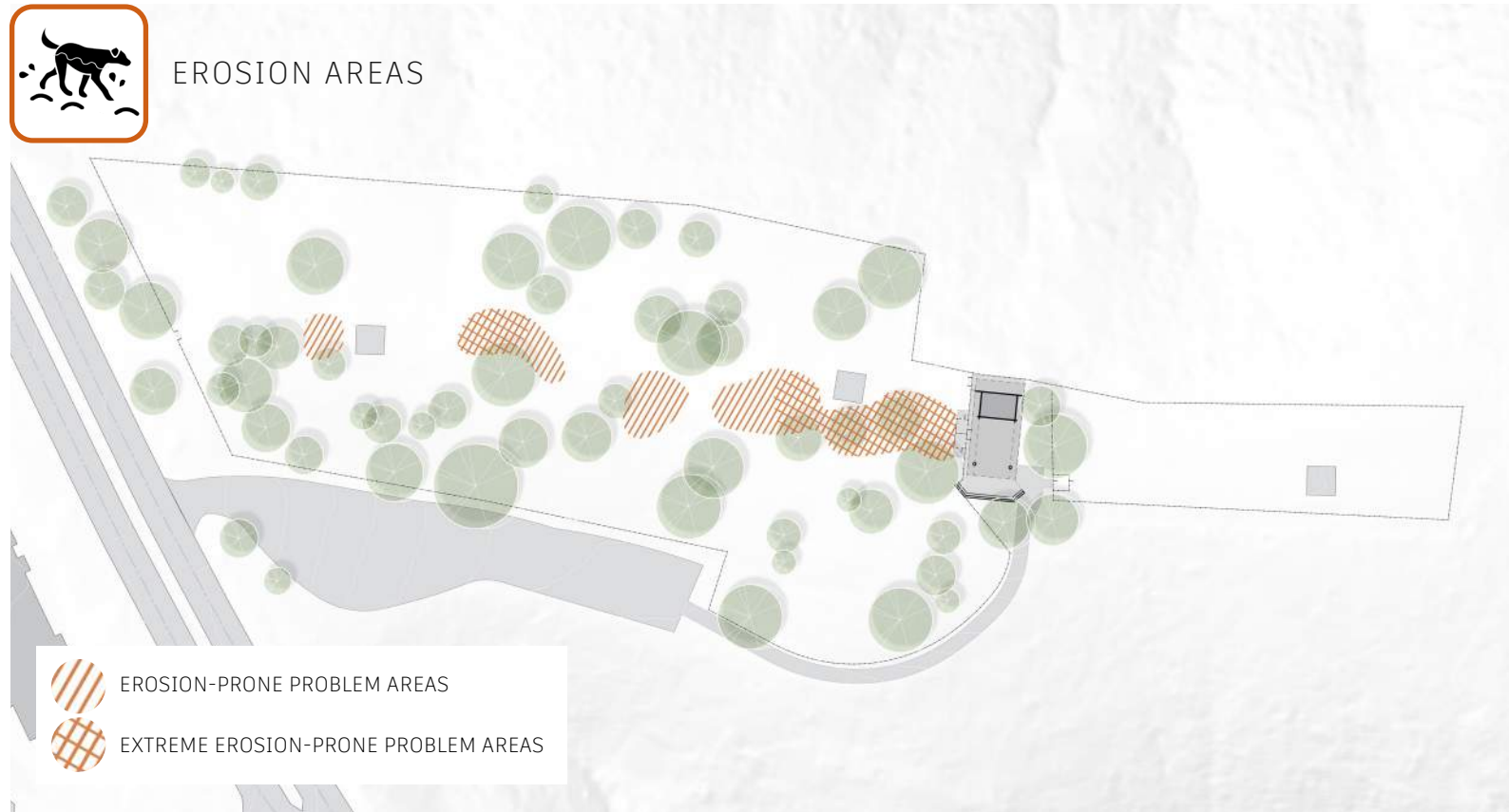

# DESIGN DRIVERS

Overlaying these site factors can often lead to designs starting to reveal themselves. Places which are erosion-prone and where dogs actively play overlap, and are the best candidates for resurfacing. The middle, or “ridge”, of the park should be treated as the primary core of the dog play zone. Places where people naturally congregate should have concentrated amenities and be on the dog run perimeter.

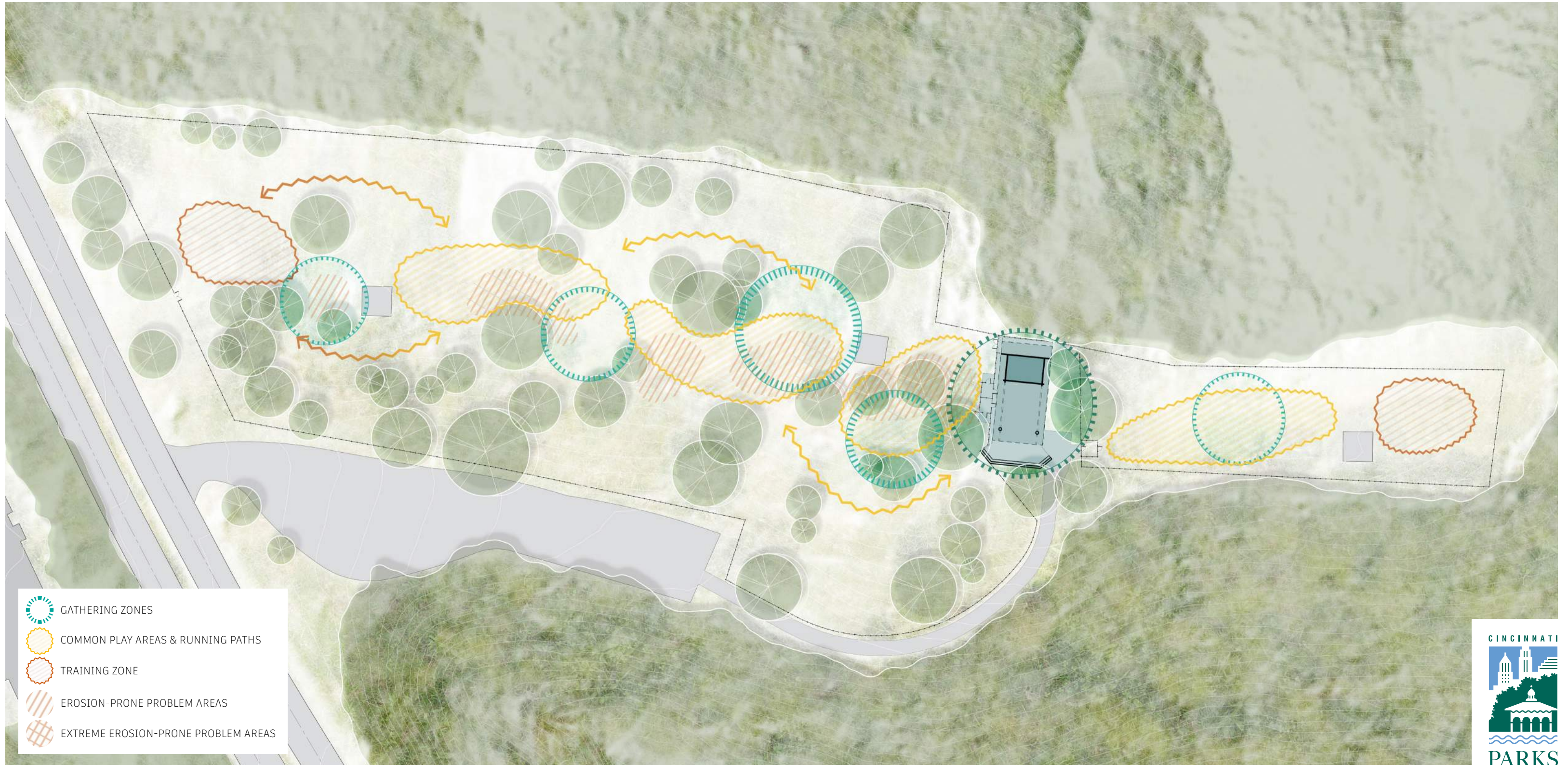

# EARLY DESIGN SKETCHES

After an analysis of site and use factors, initial sketches were made that centered around the idea of providing the dog run at the spine of the park, while organizing seating pods at its perimeter to foster community togetherness.

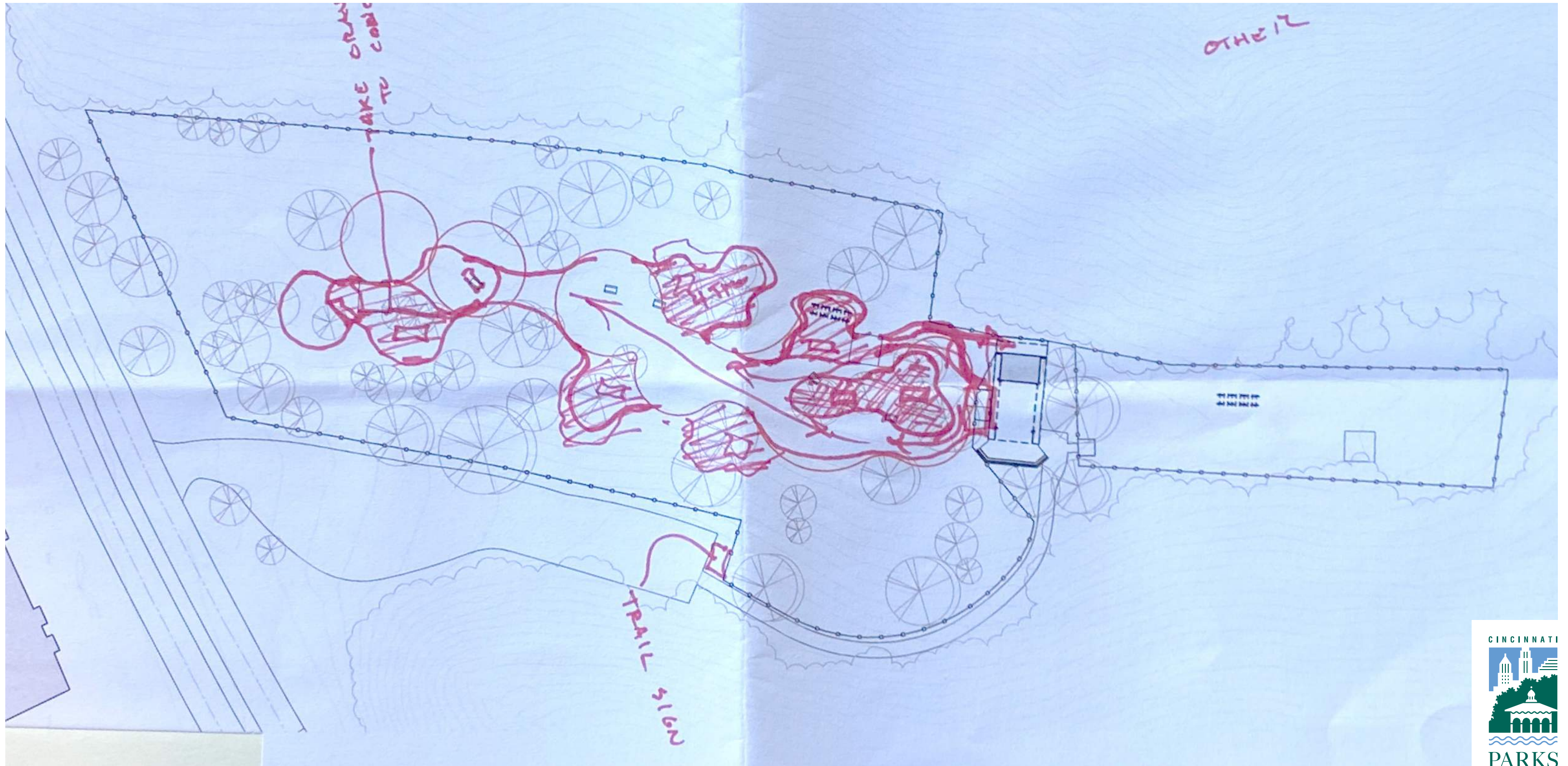

# DESIGN CONCEPT - LONG DOG RUNS W/ ANCILLARY GATHERING NODES

- Capitalizes on long runs for energetic dogs
- Reduced impact of erosion, improving maintainability.
- Maintains important features, such as water amenities and shaded structures.
- Organizes gathering areas to foster community togetherness.
- Trash amenities on park perimeter for access and ease of maintenance.

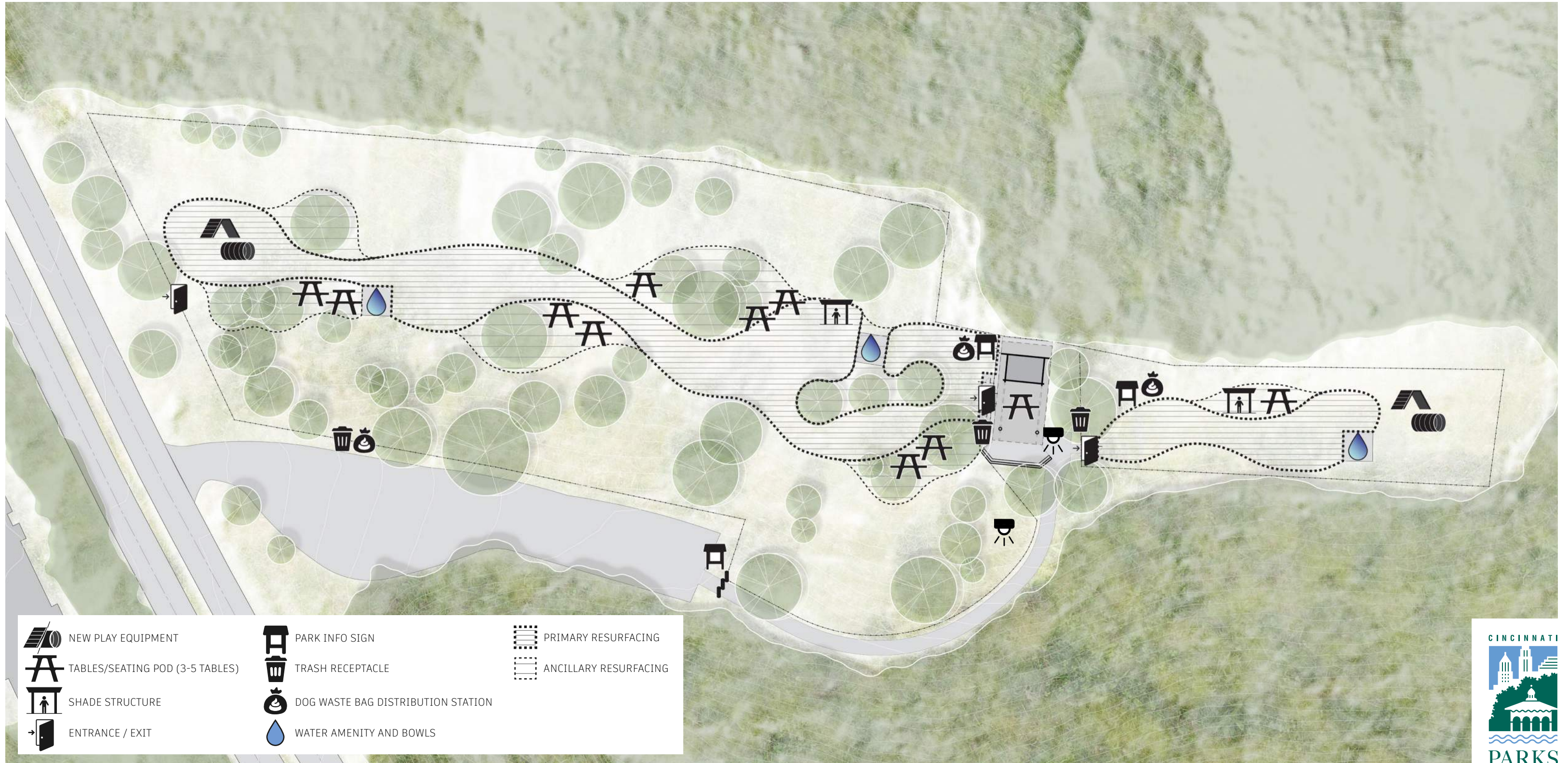



**THANK YOU**



<https://www.surveymonkey.com/r/DorisDayDogPark>